

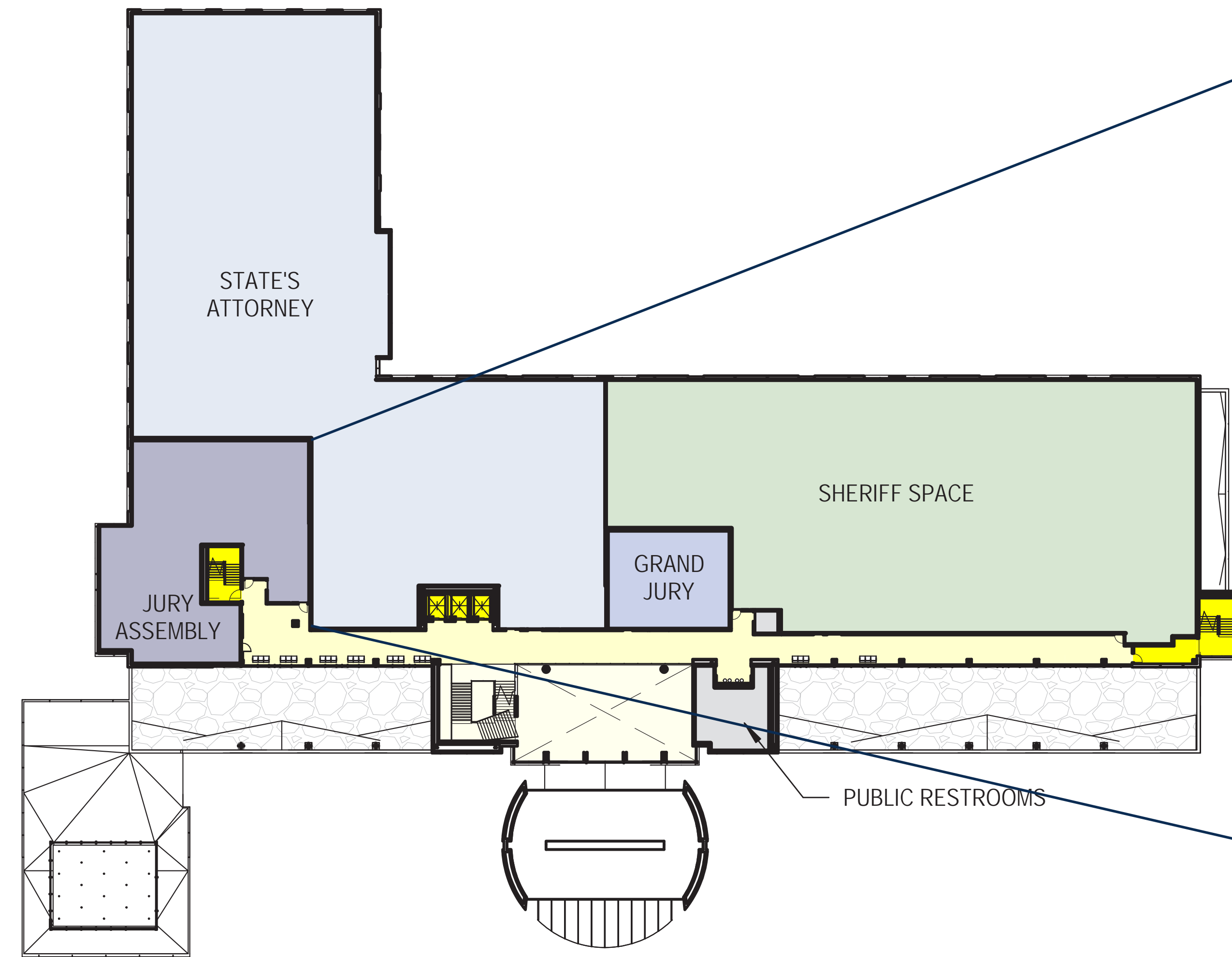

INTERIOR ARCHITECTURE

SECOND FLOOR

- Jury Assembly Hall
- States Attorney's Office
- Sheriff's Office
- Public Restrooms
- Public Art Installations



JURY ASSEMBLY HALL

GROUND FLOOR

- Security Screening Area
- Clerk Of The Courts Office
- Register Of Wills Office
- Orphan's Court
- Law Library/Pro Se Clinic
- Public Wellness Resources
- Food Service
- Public Restrooms
- Public Art Installations

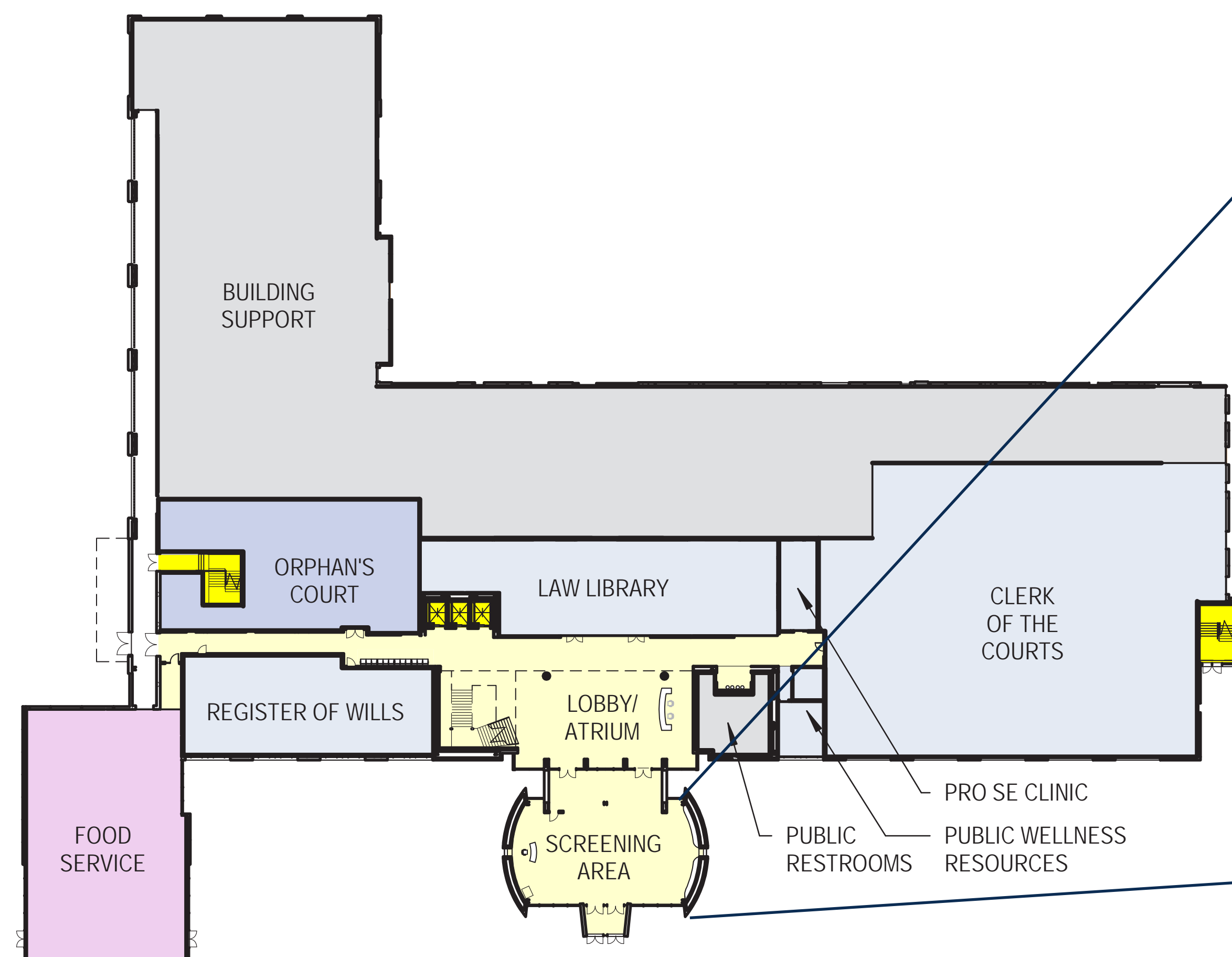

SECURITY SCREENING AREA



INTERIOR ARCHITECTURE

THIRD FLOOR

- 2 Courtrooms
- 3 Hearing Rooms
- Attorney/Client Conference Rooms
- Multi-Use Community Room
- Public Defender
- Social Services
- Juvenile Services
- Hopeworks
- Public Restrooms

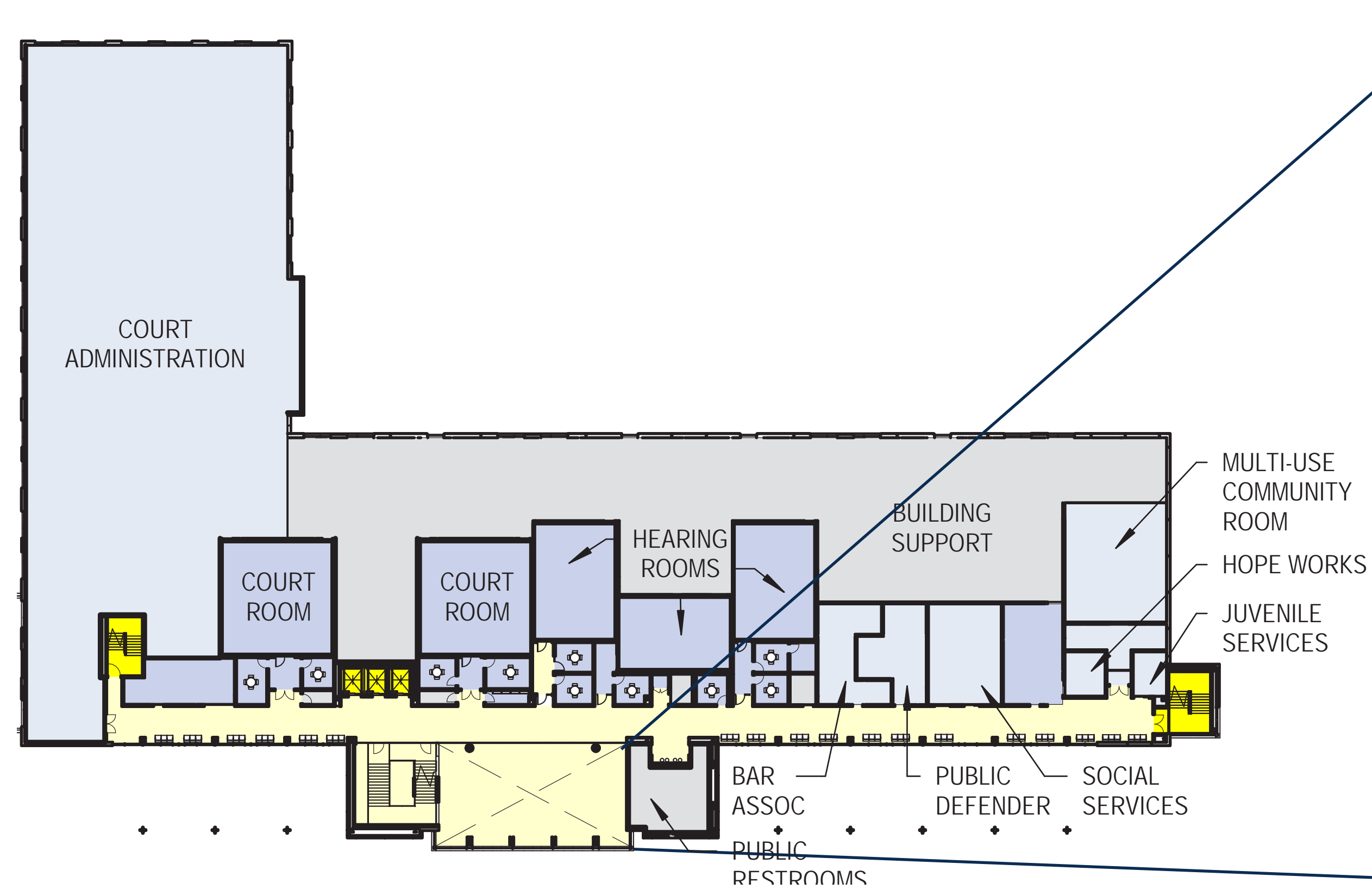

PUBLIC LOBBY / ATRIUM

FOURTH FLOOR

- 6 Courtrooms
- Attorney/Client Conference Rooms
- 2nd Multi-Use Community Room
- Public Restrooms

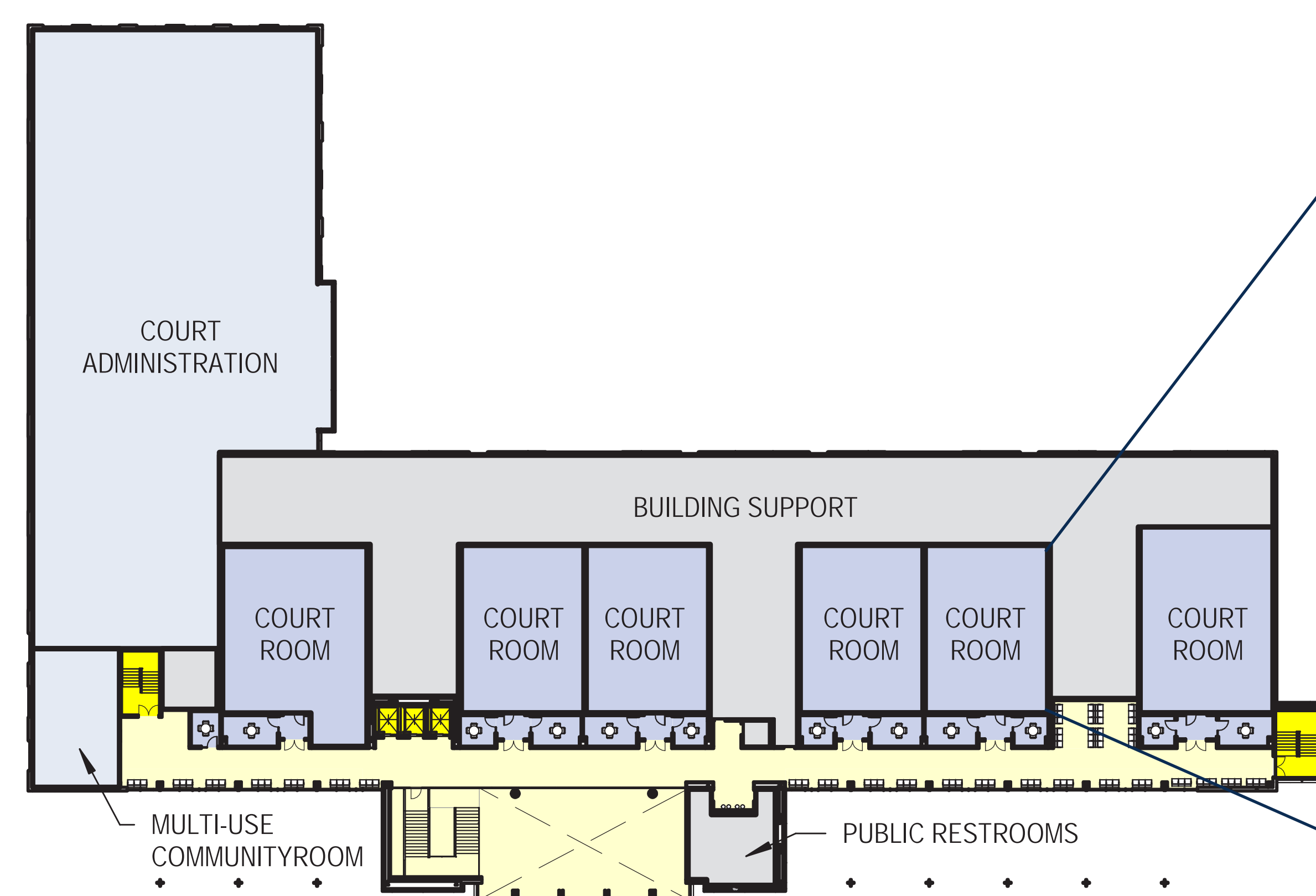

COURTROOM



EXTERIOR ARCHITECTURE

Four-story day-lit atrium enhances the sense of arrival as the public approaches and enters the building

The central atrium is flanked by a modern interpretation of the classic colonnade, common in traditional courthouses

SUSTAINABILITY: extensive glazing permits natural light to fill the public spaces without the need for daytime lighting.

The approach to the courthouse is simple and direct, the front door and drop off court are easily identified

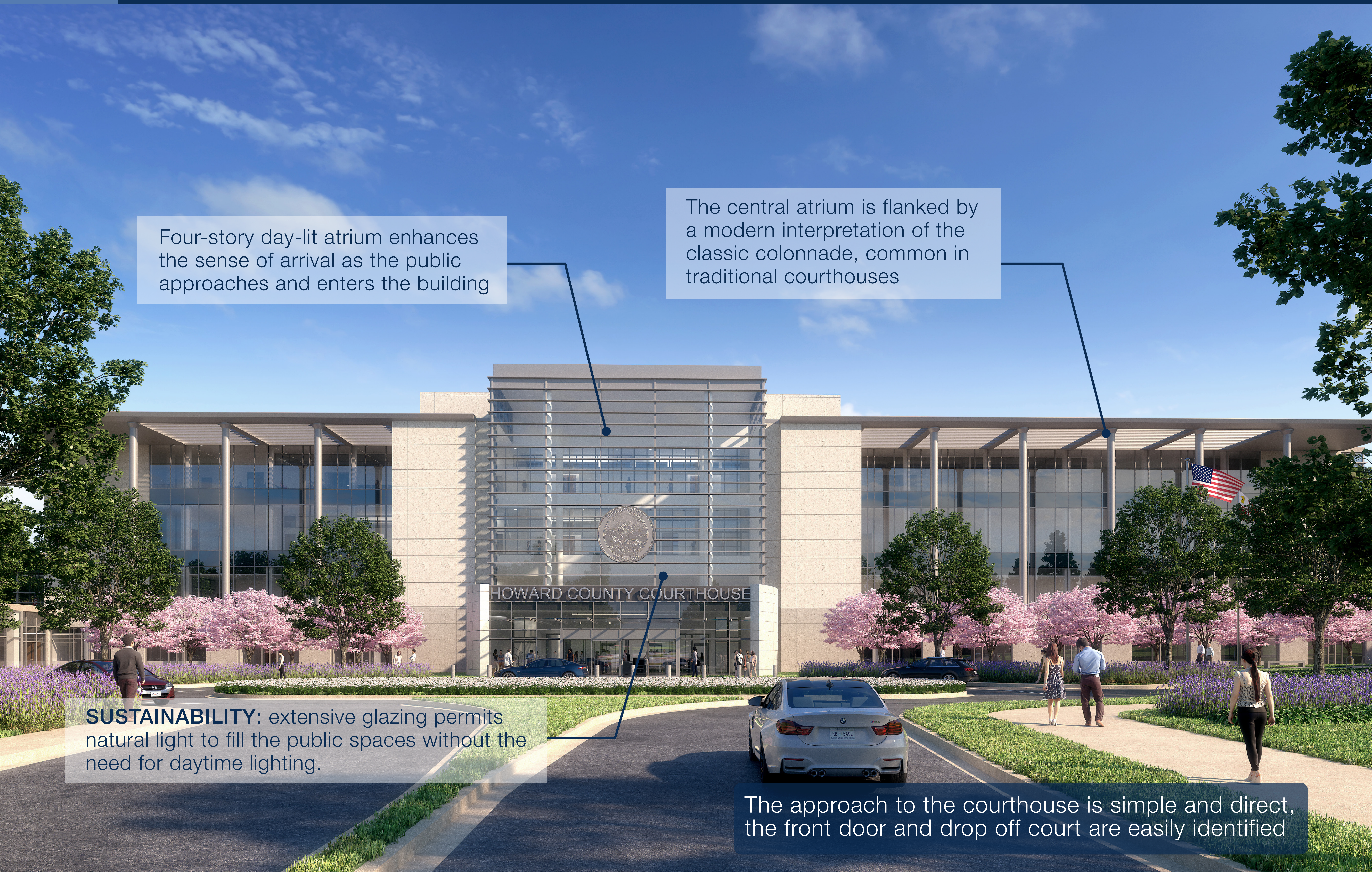



EXTERIOR ARCHITECTURE

SUSTAINABILITY: The shade canopy reduces heat gain and glare and improves the quality of light and comfort of visitors in the courthouse's public halls

A pleasant stroll along the elegantly landscaped and level path links the parking garage to the building entrance

Public art installations will line the path to enhance the exterior appearance

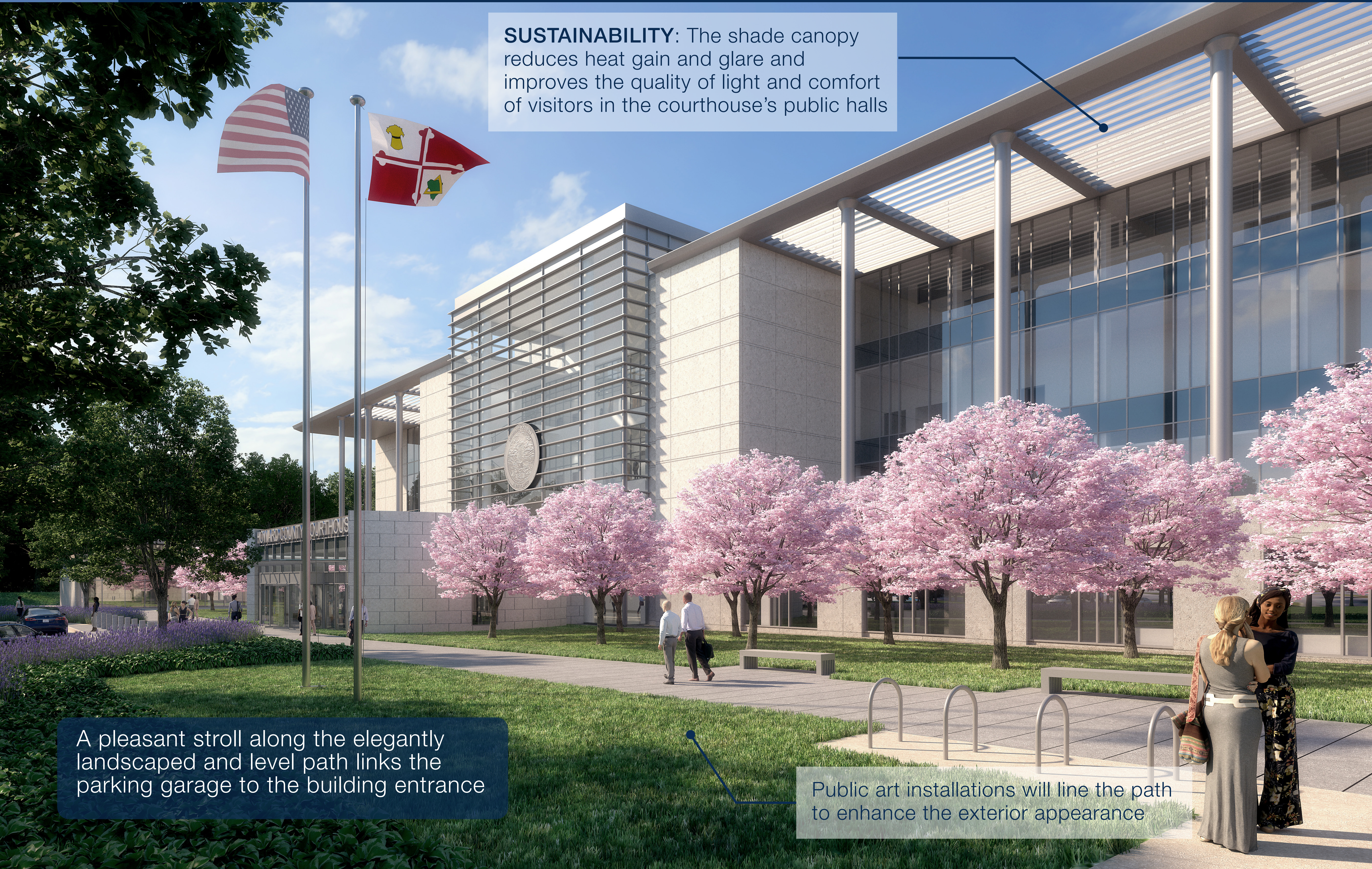



EXTERIOR ARCHITECTURE



Current Approaching View



Potential Future Expansion



Future Approaching View



ENVIRONMENTAL DESIGN

THE PROJECT WILL RESULT IN OVER **50% REDUCTION OF IMPERVIOUS SURFACE**



EXISTING SITE CONDITION

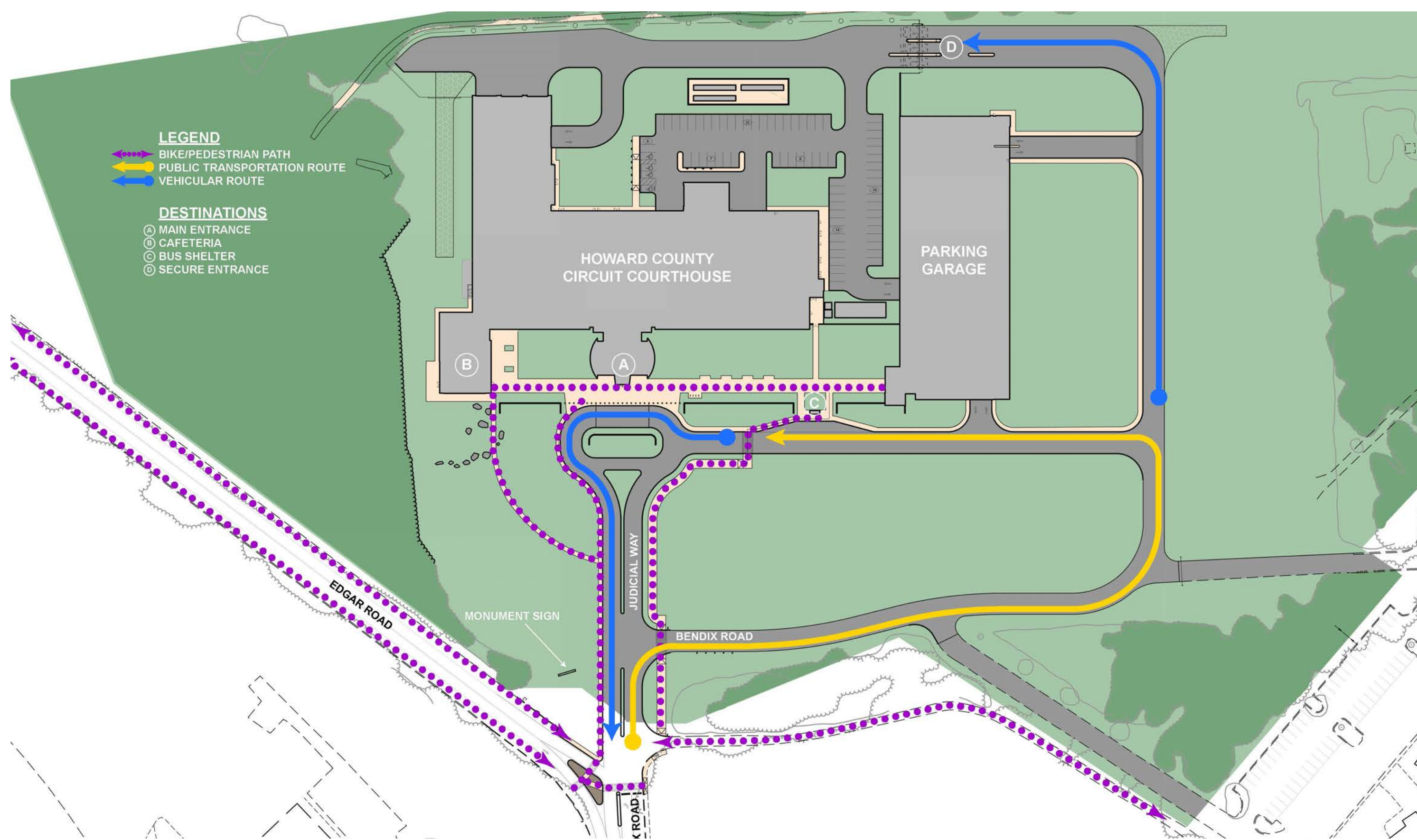

PROPOSED SITE CONDITION



LEED SILVER CERTIFIED BUILDING

BUILDING DESIGN

- Sun shading on south facing facades
- High performance building skin
- High efficiency mechanical systems
- LED light fixtures
- Water saving plumbing fixtures
- Low VOC and recycled materials
- Reduced building footprint

SITE DESIGN

- No existing trees removed
- Over 100 new trees planted
- Bike path/storage
- Bus stop on site
- Reduced parking footprint
- Dedicated electric and fuel efficient vehicle parking
- Regional planting species



ENVIRONMENTAL DESIGN

Sun shades control glare and reduce solar heat gain

Durable long casting materials sourced regionally

Over 100 new trees planted; no existing trees removed

HOWARD COUNTY COURTHOUSE



Energy efficient, high-performance building reduces energy consumption by over 30%



TRAFFIC IMPROVEMENTS

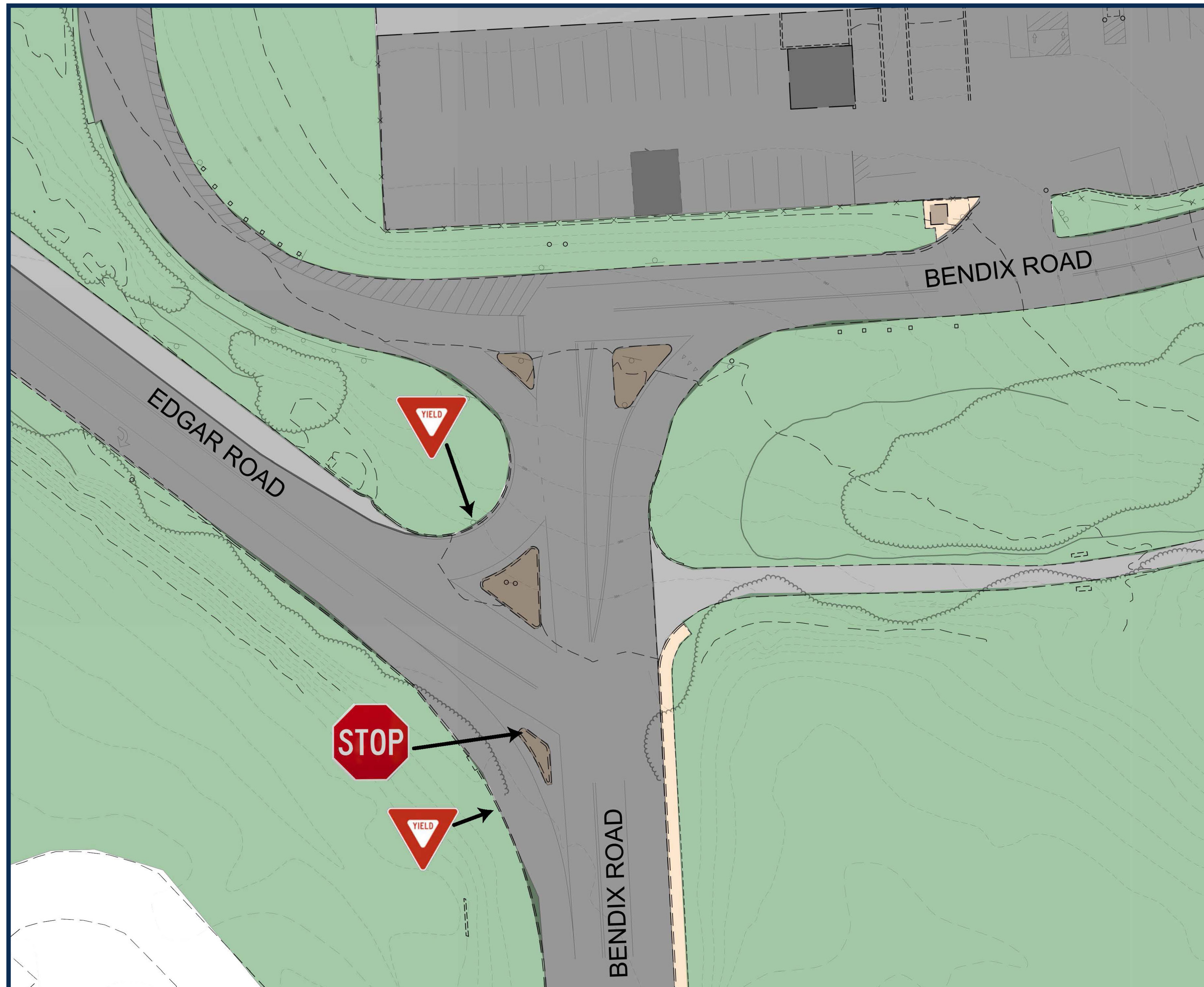

CURRENT INTERSECTION OF EDGAR RD & BENDIX RD

- Traffic directed to Edgar Road
- Unsafe pedestrian & bicycle pathways

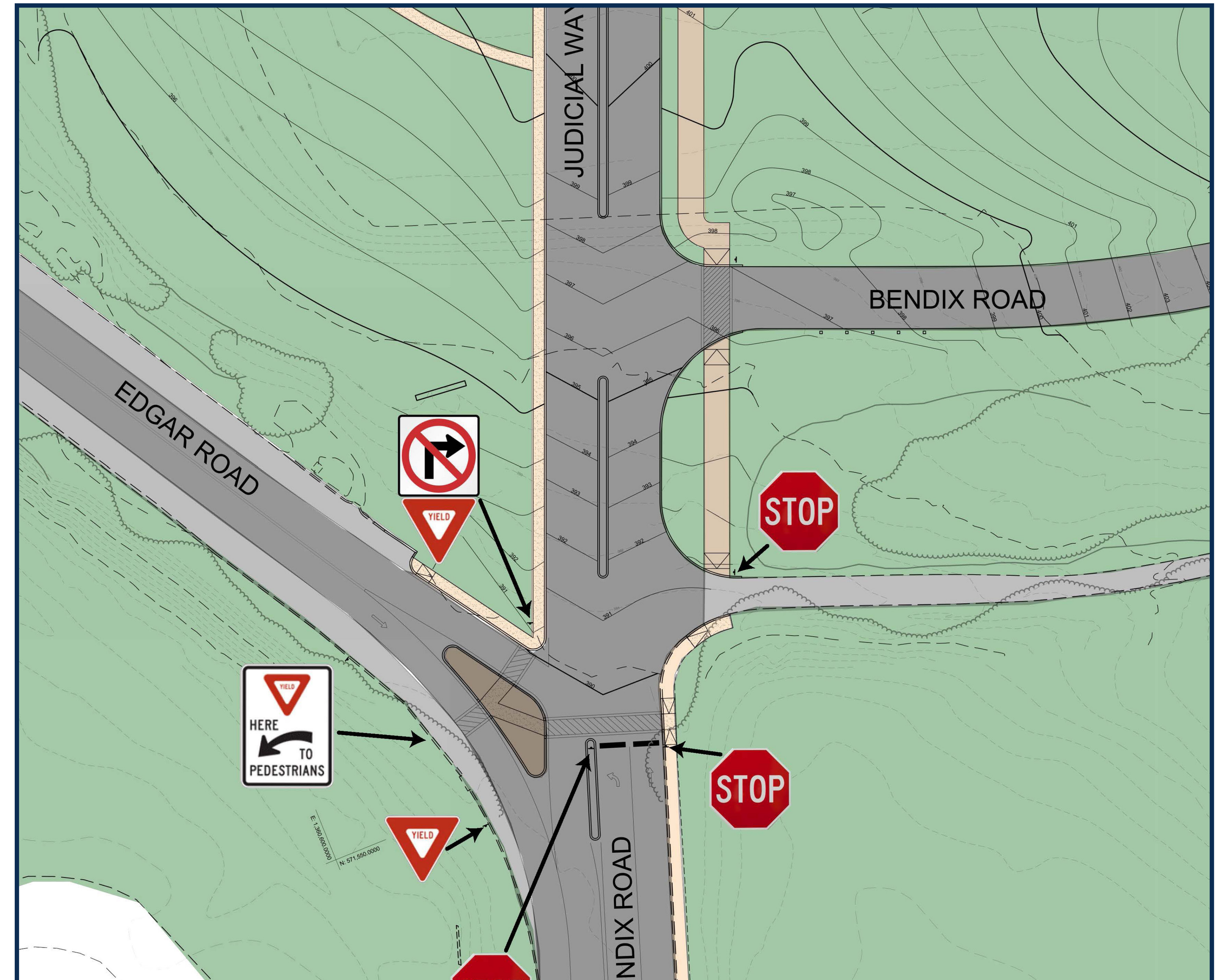

FUTURE INTERSECTION OF EDGAR RD & BENDIX RD

- Courthouse traffic blocked from using Edgar Road
- Enhanced pedestrian & bicycle safety within new crossing dedicated pathways
- Final traffic control still under study



TRAFFIC IMPROVEMENTS

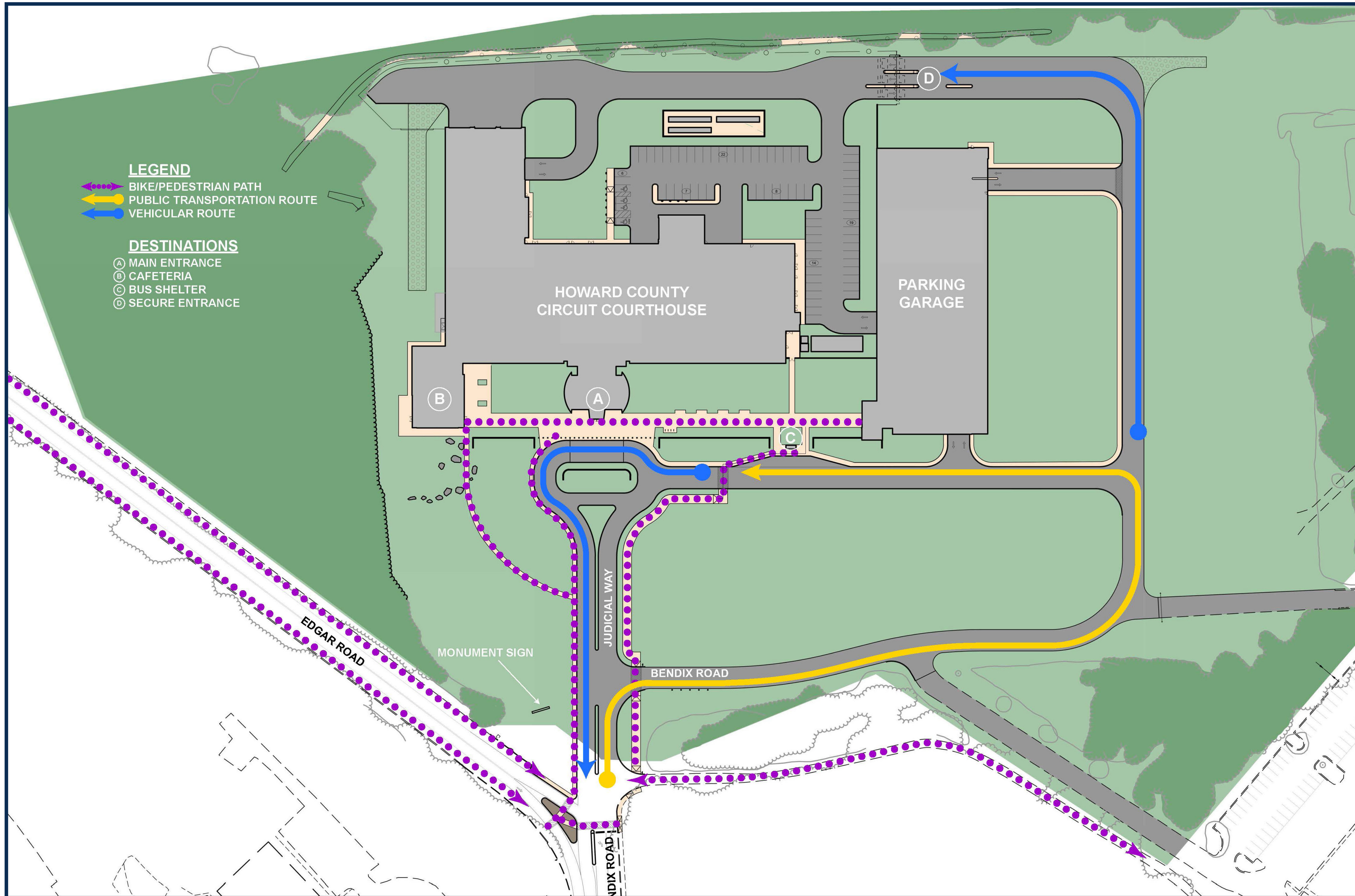

FUTURE TRAFFIC PATTERNS

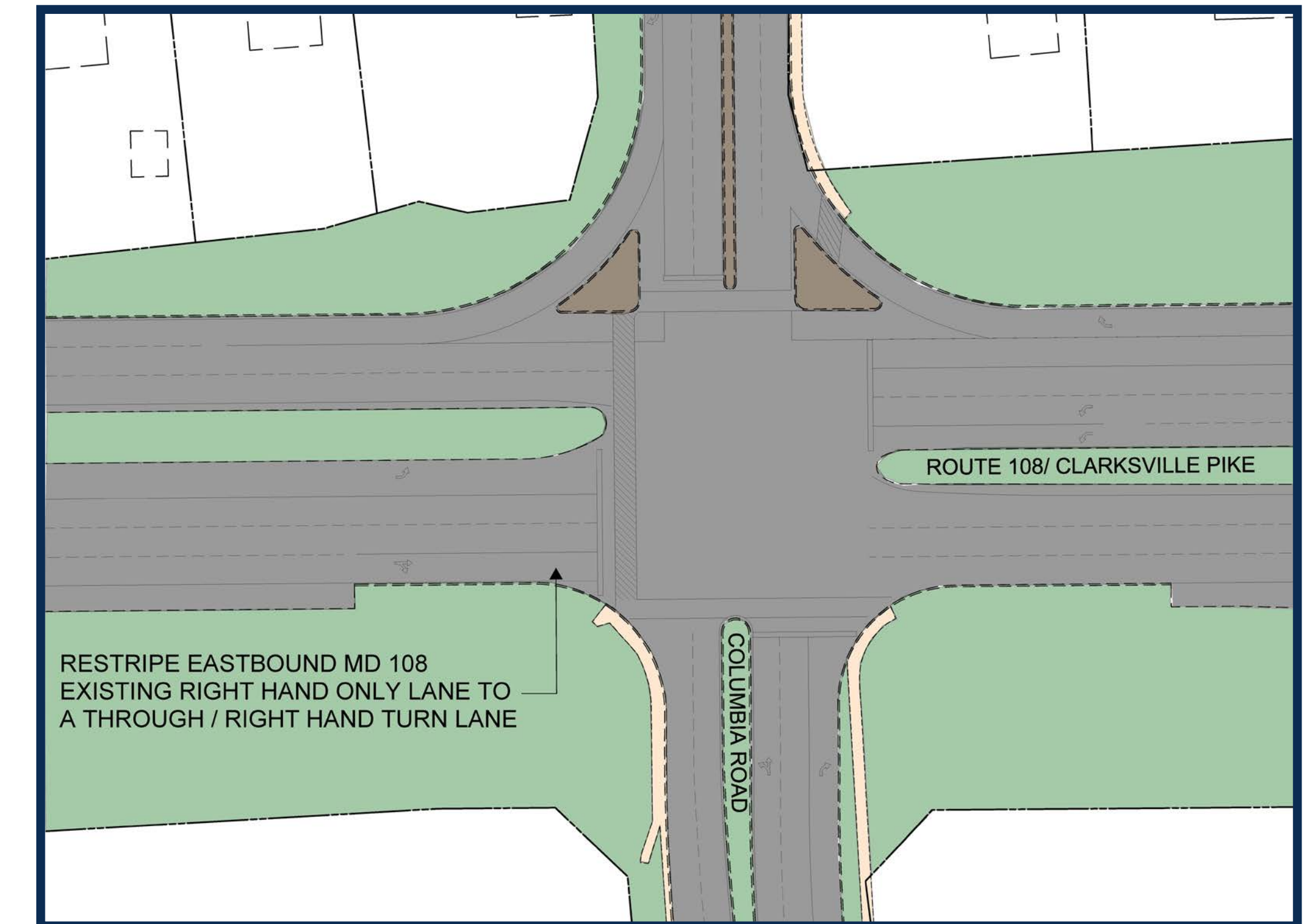

ROUTE 108 & COLUMBIA RD INTERSECTION IMPROVEMENTS



CURRENT SITE CONDITIONS



SITE PLANNING



LEGEND

- ① PROPERTY LINE
- ② BUILDABLE AREA
- ③ 82' FORCE PROTECTION SETBACK
- ④ SITE ENTRY SIGNAGE
- ⑤ BUILDING MAIN ENTRANCE
- ⑥ VISITOR DINING ENTRANCE
- ⑦ PEDESTRIAN GARAGE ENTRANCE
- ⑧ PARKING GARAGE ENTRANCE
- ⑨ VEHICLE SECURITY ENTRANCE
- ⑩ SHERIFF PARKING ENTRANCE
- ⑪ SHERIFF PARKING SECOND EXIT
- ⑫ SHERIFF PARKING (75)
- ⑬ JUDGE PARKING ENTRANCE
- ⑭ JUDGE PARKING (20)
- ⑮ LOADING AREA
- ⑯ ANTI-RAM WEDGE BARRIER
- ⑰ CONTROLLED GATE
- ⑱ UNAUTHORIZED VEHICLE TRUNAROUND
- ⑲ TRUCK/ DETAINEE ENTRANCE LANE
- ⑳ JUDGE/ SHERIFF ENTRANCE LANE
- ㉑ EXIT LANE
- ㉒ SECURITY FENCE
- ㉓ ANTI-RAM BOULDER
- ㉔ AC CHILLERS
- ㉕ EMERGENCY GENERATOR
- ㉖ MAIN ENTRANCE DROP OFF PLAZA
- ㉗ SAFETY BOLLARDS
- ㉘ BUS DROP OFF AREA
- ㉙ BUS SHELTER
- ㉚ ASPHALT SHARED USE PATHWAY
- ㉛ BIKE RACK
- ㉜ CIVIC GREEN SPACE
- ㉝ FLAG POLES (2)
- ㉞ TREE BOSQUE
- ㉟ OUT DOOR DINING TERRACE
- ㊱ LANDSCAPE HEDGE PLANTING
- ㊲ LANDSCAPE PATH
- ㊳ SIDEWALK CONNECTING TO EXISTING
- ㊴ SALLY PORT - DETAINEE ENTRANCE
- ㊵ FIRE TRUCK LANE / TRUCK TURNING
- ㊶ FUTURE BUILDING EXPANSION





SITE PLANNING



LEGEND

- ① PROPERTY LINE
- ② BUILDABLE AREA
- ③ 82' FORCE PROTECTION SETBACK
- ④ SITE ENTRY SIGNAGE
- ⑤ BUILDING MAIN ENTRANCE
- ⑥ VISITOR DINING ENTRANCE
- ⑦ PEDESTRIAN GARAGE ENTRANCE
- ⑧ PARKING GARAGE ENTRANCE
- ⑨ VEHICLE SECURITY ENTRANCE
- ⑩ SHERIFF PARKING ENTRANCE
- ⑪ SHERIFF PARKING SECOND EXIT
- ⑫ SHERIFF PARKING (75)
- ⑬ JUDGE PARKING ENTRANCE
- ⑭ JUDGE PARKING (20)
- ⑮ LOADING AREA
- ⑯ ANTI-RAM WEDGE BARRIER
- ⑰ CONTROLLED GATE
- ⑱ UNAUTHORIZED VEHICLE TRUNAROUND
- ⑲ TRUCK/ DETAINEE ENTRANCE LANE
- ⑳ JUDGE/ SHERIFF ENTRANCE LANE
- ㉑ EXIT LANE
- ㉒ SECURITY FENCE
- ㉓ ANTI-RAM BOULDER
- ㉔ AC CHILLERS
- ㉕ EMERGENCY GENERATOR
- ㉖ MAIN ENTRANCE DROP OFF PLAZA
- ㉗ SAFETY BOLLARDS
- ㉘ BUS DROP OFF AREA
- ㉙ BUS SHELTER
- ㉚ ASPHALT SHARED USE PATHWAY
- ㉛ BIKE RACK
- ㉜ CIVIC GREEN SPACE
- ㉝ FLAG POLES (2)
- ㉞ TREE BOSQUE
- ㉟ OUT DOOR DINING TERRACE
- ㊱ LANDSCAPE HEDGE PLANTING
- ㊲ LANDSCAPE PATH
- ㊳ SIDEWALK CONNECTING TO EXISTING
- ㊴ SALLY PORT - DETAINEE ENTRANCE
- ㊵ FIRE TRUCK LANE / TRUCK TURNING
- ㊶ FUTURE BUILDING EXPANSION

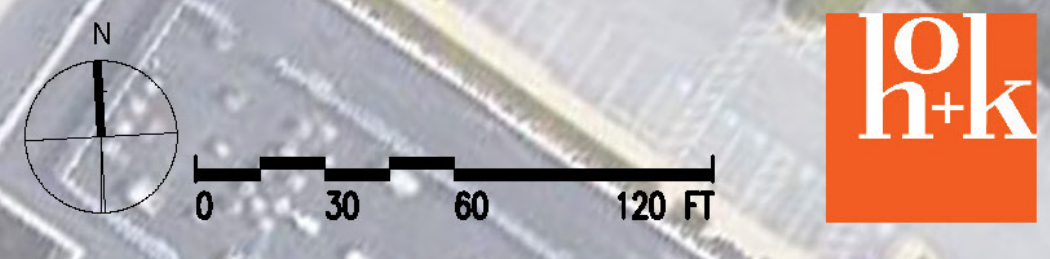



SITE PLANNING





SCHEDULE

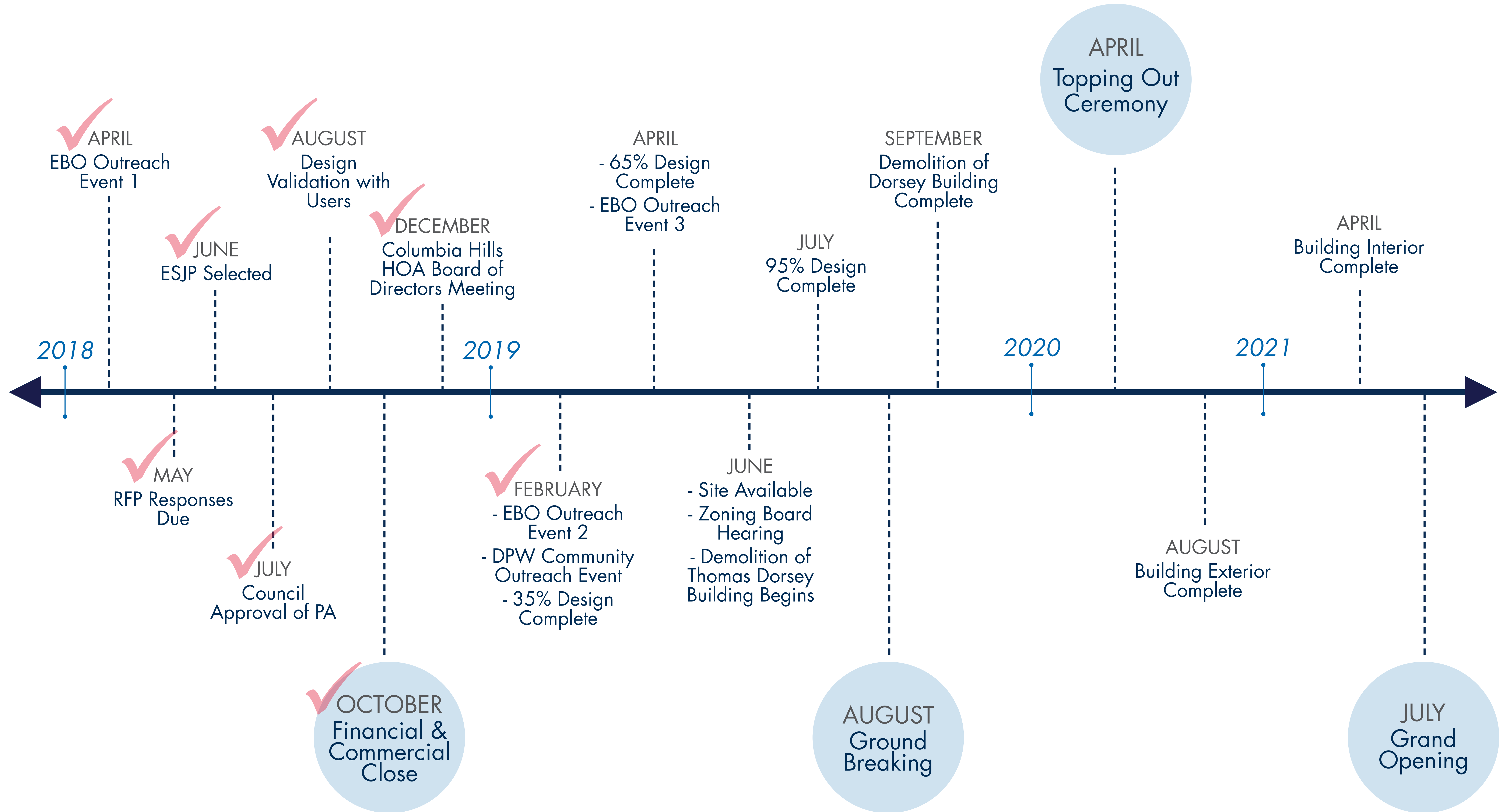



BUILDING A LOCAL TEAM

OPPORTUNITIES FOR LOCAL COMPANIES

Procurement for the design team and development team is complete; however, the process of building the construction team is still underway through 2019.

So far, 17 Maryland-based companies have been added to the team, 10 of which are minority, woman, disabled, or veteran-owned businesses.

17
Maryland Project Partners

10
M/W/D/VBE Firms

BIDDING OPPORTUNITIES

Available at: www.howardcountymd.gov/HowardCourthouse

TIMELINE

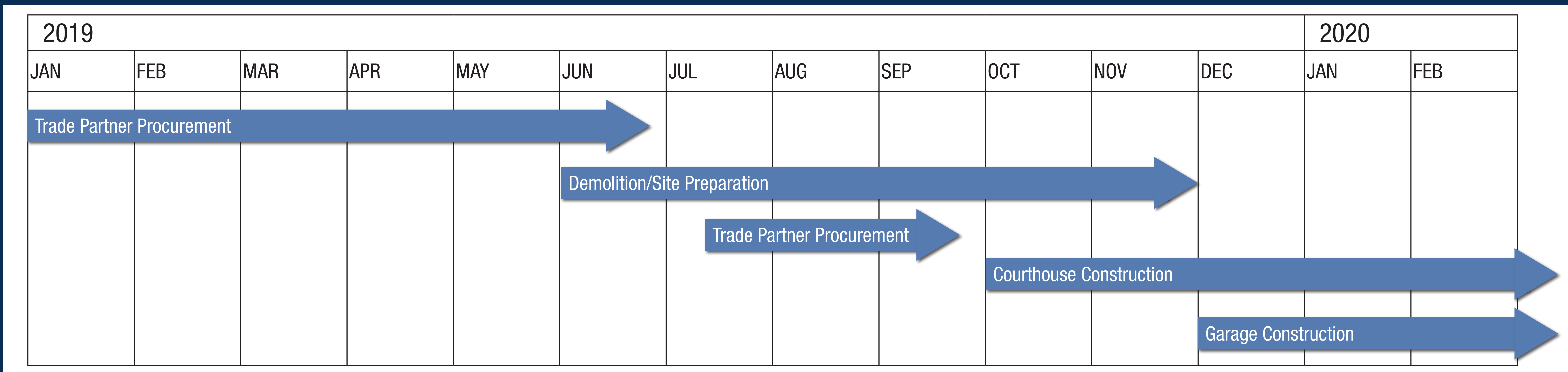



STRATEGIC PARTNERSHIP PROGRAM

PROGRAM HIGHLIGHTS

- Industry-leading program since 2006
- Executive MBA-style education
- Zero cost to participating firms
- Over 700 participating M/W/DBE and small business company leaders
- More than \$850 million in contracts awarded

CURRICULUM

- Financial statements and accounting
- Insurance and bonding
- Architectural blueprint reading
- Understanding contracts
- Estimating and purchasing
- Project management
- Presentation skills





TRADES BIDDING

CONSTRUCTION

- Aggregate Piers
- Applied Fireproofing
- Ceramic Tile
- Chemical & Biological Detector
- Decorative Metal Security Fences
- Detention Equipment & Enclosures
- Doors, Frames, & Hardware
- Elastometric Liquid Flooring
- Electrical
- Entrances Floor Mats & Frames
- Final Cleaning

- Formed Metal Panels
- Interior Arch Woodwork
- Landscaping
- Masonry
- Material Hoist Operator
- Mechanical
- Metal Fabrication
- Ornamental Metals
- Overhead Doors
- Painting
- Parking Control Equipment

- Pavement Markings
- Residential Appliances
- Resilient Base & Accessories
- Roller Window Shades
- Rough Carpentry
- Specialties
- Spectator Seating
- Termite Control
- Terrazzo Flooring
- Unit Paving

OPERATIONS & MAINTENANCE

- Asphalt (Intermittent)
- Carpet Cleaning
- Exterior Window Cleaning
- Garage Maintenance
- Janitorial Services
- Landscaping
- MEP

- On-Site Labor
- Patch And Paint
- Pest Control
- Roads And Grounds
- Roofing (Intermittent)
- Snow Removal
- Waste/Recycling

Pricing and bidding for O&M subcontractor specialties will begin approximately 6-8 months prior to building occupancy (Fall 2021)



LET'S KEEP IN TOUCH



Visit howardcountymd.gov/HowardCourthouse for updates and information on the project.



Questions? Contact Howard County at build@howardcountymd.gov